



084-0881847 / 086-5487333



@chicjourney



chic-2020.com



chicjourney2020



CRUISE STARTS
JUL 5, 2025

CRUISE ENDS
JUL 12, 2025

DURATION
7 DAYS

SHIP
SILVER DAWN

Itinerary & Excursions

7 PORTS

2 COUNTRIES

BERGEN TO COPENHAGEN

VOYAGE NUMBER #DA250705007

FEATURED OFFERS



FAMILY SAVINGS

SAVE. INDULGE. EXPLORE.

FROM

~~\$6,200~~
\$4,700

PER GUEST

WITH LOWEST FARE AVAILABLE

Come and discover how delightful Norway is on this voyage which takes in the best of the best of this charming region. Embark in Bergen and continue on to charming towns Åndalsnes, Trondheim and Ålesund to name just a few. You'll be dazzled by the deep blue fjords, emerald forests and pretty architecture. The food and drink are incredible, and the locals are warm and full of Nordic charm. Enjoy a day at sea before arrival in Copenhagen.



The crooked, pastel-coloured warehouses of Bergen's World Heritage waterfront lean together charmingly, welcoming visitors to this city at the heart of Norway's most extraordinary cinematic landscapes. It may be the country's second largest city, but the villagey feel here always provides a warm welcome - even when the weather is living up to its famously damp reputation. Bergen's colourful waterfront, Bryggen, is a ramshackle line-up of incredible Hanseatic warehouses, built following the devastating fire of 1702, which ransacked the city. These iconic warehouses have stood proudly ever since, with Bergen growing and expanding around the colourful facades. Behind them, a labyrinth of narrow alleyways and wooden decking waits, alive with artisan craft shops and bustling galleries. Fløyen mountain watches over the city, and you can take a short but steep hike up to the panoramic viewpoints, or jump on the funicular, which trundles visitors up and down the incline. At the top, spectacular views of Bergen jutting out into the dark seas below unfold before your eyes. Wait until evening to see the sunset painting glorious golden light across the city and waves, and Bergen's lights flickering into life. Nærøfjorden, a deeply etched fjord nearby, is perhaps Norway's most photographed and iconic piece of scenery. A cruise through the base of this spectacular narrow fjord, parting the glass-smooth inky waters, is an utterly humbling experience, as the claustrophobically-close slopes rise imposingly over you. Sognefjord also stretches out nearby, and is Norway's longest fjord, adorned with plunging waterfalls and vibrant farms during summer.



Decorative turrets, pastel-coloured paint and elegant buildings reflect in the glass-smooth harbour waters of Ålesund, welcoming you to one of the world's finest havens of Art Nouveau architecture. A perfect complement of natural and man-made beauty, the city's distinctive jugendstil style is enhanced by a thrilling location amid colossal fjord scenery. Undoubtedly one of the most beautiful towns in Norway, practically every building in Ålesund boasts fantastical flourishes and eccentric quirks. Rebuilt from the ashes of the devastating fire that swept through in 1904, the town is now a unique historic treasure trove. Wander fairy-tale cobbled streets,

and admire endless dainty turrets and decorative swirls, before reaching the Aksla Viewpoint and letting the true majesty of the town's dreamlike setting wash over you, while gazing over its archipelago. Enjoy a sugar-kick with a bite of folded svele – an indulgent, buttery Norwegian pancake - or settle in to a cosy restaurant for something a little more substantial. Ålesund is a town built on sea trade, and a regular haul of fjord cod is brought ashore before being distributed right across the world. Dried, salted cod – known as klipfish – is a particular speciality, with Ålesund producing an incredible two thirds of the world's supply.



A colourful, historic capital of Norway, Trondheim's history reaches back to 997 AD, when it was founded by Viking King Olav Tryggvason. It may be Norway's third-biggest city, but there's a welcoming and intimate feel here, with a photogenic waterfront, and glowing wooden warehouses adding old-time charm. The history runs deep, but nowadays Trondheim is also a leading technology centre, and home to 30,000 students, who inject youth and vitality into the city's streets. Museums dedicated to Norway's musical heritage will strike a sweet chord, while the endless wilds of central Norway and the Trondheim Fjord unveil themselves close by. A destructive

fire laid to rest to old Trondheim's narrow wooden alleyways, but a flavour of the old city survives in the Bakklandet neighbourhood. Traditional timber houses and colourful wharves line up along the waterfront, painting a pretty picture with pistachio-green and turmeric-yellow licks of paint. Vibrating cyclists rattle along the cobbled old streets, while flowers spill down from window ledges in this quaint, but lively area of cafes, restaurants and curiosity shops. Head to the Old Town bridge - Gamle Bybro - to enjoy the colourful lines of houses on both sides of the river, on your way to the gothic Nidaros Cathedral, which towers above the city, with its pointed, emerald-green spire punctuating the sky. The most northerly Gothic cathedral in Europe, aim to visit during one of the organ performances that rattle the beautiful stain-glass windows. Built on the burial site of King Olaf, in 1070, you can test your knees by taking on the narrow ascent of the tower, where glorious views of Trondheim await. Take in the beauty of the city with a trundling tour aboard the most northerly tram in the world - Gråkallbanen.



Åndalsnes is located at the mouth of the river Rauma, at the shores of the Romsdalsfjord, one of the fjords protected as a UNESCO world heritage site. Famous in the 19th century for salmon fishing, the Rauma flows through the Romsdalen Valley widely considered some of the most breathtaking scenery in all of Norway. Although the river's salmon stocks are now being replenished, today Andalsnes is better known as a centre of excellence for Norwegian alpine sports. Mountaineering, climbing, hiking and even base jumping are all readably accessible. A newly opened Norwegian Mountaineering centre boasts Norway's

highest indoor climbing wall. Some 15 kms out of Andalsnes is the Trollstigen (Troll Road), a mountain road that climbs the pass between the Isterdalen and Valldal valley. It's one of Norway's major attractions due to the steep inclines and eleven hairpin bends, only open in the summer months. Equally exciting is a three hour round rail trip from Andalsnes to Dombas on the Rauma Railway line. A feast for the eyes from the comfort of a carriage, mountains, valleys and waterfalls come into sight, as the route follows the Rauma river. Trains thoughtfully slow down at the most photogenic spots. A feat of civil engineering the track passes over countless bridges and through tunnels, the train even performs a 180 degree turn underground. Easily missed, look out at the train station in Andalsnes for a chapel converted from an old red "Intercity Special" railway carriage. The only train chapel in Norway and perhaps the world!



Day 5**Olden, NORWAY****WED, JULY 9****07:00 - 18:00**

Quaint wooden farmhouses sit below jagged mountain peaks, in this land of superlative natural features. Witness nature at its most spectacular, as you visit tiny Olden - a village of just 500 people, which is swallowed whole by its colossal surroundings. The village nestles at the mouth of the Oldeelva River, on the southern banks of Norway's sixth-longest fjord, Nordfjord. Embark on dreamy lake cruises, confront cascading glaciers, and ascend to staggering viewpoints to survey the majesty from above. Olden is surrounded by valleys, carved by the slow grind of mighty glaciers, peeling off from immense ice caps. See mainland Europe's

largest, Jostedalsgreen, with its 22 arms spilling down into branches, which rest between mountains. Head for the blue-white terminus of the Briksdal Glacier, to admire the icy expanse up close, and hike the deeply picturesque surroundings. From Olden, you can sail out on the smooth waters of the scenic Nordfjord, or calmly kayak across its glassy surface, observing sharp peaks and cascading waterfalls. Take a coffee break at Lovatnet Lake – be sure to give the local waffles and strawberry jam a try – before heading out onto the gorgeous blue-green water, which is coloured by minerals and clay particles, washed in by the glacial water. The valley's bulging mountain walls tower above you, as you glide across the magical surface. Nearby you'll find the slightly larger village of Loen. Jump on the Skylift, and you can reach the bill-topping view from the 1,011-metre tall perch of Mount Hoven, where a spread of villages, fjords and mountains is set before you.

Day 6 Day at sea, International Waters**THU, JULY 10**

Days at sea are the perfect opportunity to relax, unwind and catch up with what you've been meaning to do. So whether that is going to the gym, visiting the spa, whale watching, catching up on your reading or simply topping up your tan, these blue sea days are the perfect balance to busy days spent exploring shore side.

**Day 7 Kristiansand, NORWAY****FRI, JULY 11****08:00 – 15:00**

The summer getaway of choice for Norwegians, Kristiansand basks in summer's glow and lays down a charming welcome mat for visitors from Scandinavia and beyond. While it radiates a summery, old-time holiday charm Kristiansand is certainly no sleepy fishing village, and Norway's fifth-largest city is a modern, green and culturally-rich city to explore. Posebyen Old Town is a delightful clutch of floral-shaded timber houses, glowing with splashes of pink blossom and carefully cultivated floral displays. Take a gentle stroll, smelling the hints of creamy white paints on the breeze, as fresh layers are ladled on by the locals, keeping the area spick and span. Kristiansand is a city fuelled by culture, and a packed schedule of open-air festivals means there's always something to celebrate or a show to see. The spectacular



086-5487333 / 084-0881847



@chicjourney



chic-2020.com



chicjourney2020

waterfront Kilden Performing Arts Centre is the city's new crown jewel – settle into your seat in this beautifully designed, golden wedge of a structure, and feel the swell of the resident orchestra reaching a stirring climax. With delicious seafood food, and plenty of shopping to boot, you'll be in no hurry to leave - but Kristiansand is a fantastic jumping-off point for unravelling Southern Norway scenic coastline of quiet fishing villages and scattered skerries. Sparkling waters, forested hills and the freshest air awaits as you jump aboard local ferries meandering up and down the Norwegian Riviera, navigating out to city beaches, quiet islands and scenic fjords. Relax in a boat of your own, haul huge salmon from the depths of the waters, or settle back to soak up the Norwegian sun on the beach – there's always something new and invigorating to enjoy in Norway's favourite outdoor playground.

Day 8

Copenhagen, DENMARK

SAT, JULY 12

Arrival 07:00



Effortlessly cool and down to earth, Copenhagen is a contemporary, clean and classy highlight of Scandinavia. A city built to be liveable, Copenhagen has refused to compromise, resulting in a forward-thinking metropolis that's green and clean. Swim in the waters of Havnebadet Islands during summer, or shelter from winter's bite by snuggling in beside a roaring open fire during winter. You can even hop on a train to Sweden, traversing the famous span of a Nordic Noir star - the Öresund Bridge. It takes just a touch over half an hour to step off the train in Malmö. There's only one way to truly explore Copenhagen and that's on two wheels. Easy bike hire

schemes will get you moving across this flat city, designed with bikes at the forefront of the mind. Choose a model with electronic assistance to take the strain out of any journey, giving you the freedom to whizz around and explore the modern angular architecture of the centre, and the pastoral colours of Nyhavn waterfront. Head out to the Little Mermaid statue, inspired by Hans Christian Andersen's fairy tale - the strikingly-restrained statue is the perfect landmark for Copenhagen; unshowy, self-assured and utterly irresistible. The Danish concept of hygge is very much alive here, and you'll feel that warm cosy feeling as you visit cafes illuminated by the warm glow of hanging filament bulbs, and stuffed to the brim with thick, dusty books. Home to mega-brewer Carlsberg, Copenhagen is also a city for hop enthusiasts, and there is a thriving craft brewing scene to sample. Danish Smørrebrød sandwiches are a must try, or for something a little more substantial, settle in for a culinary voyage and try a taster menu – the city's restaurants are littered with Michelin stars.

The excursions are provided as a sample of what may be offered on this voyage and are subject to change. We are constantly updating our shore excursion programme with immersive and authentic experiences, so please do not hesitate to review your tour programme choice closer to your sail date. We invite guests to visit my.silversea.com for the most updated information.

Ship - Silver Dawn



GUESTS CAPACITY: 596

CREW CAPACITY: 411

BUILT: 2021

TONNAGE: 40,700 TONS

A new world of luxury is waiting aboard Silver Dawn. Elegant and modern, Silver Dawn is the natural evolution of our fleet. Large enough to offer eight dining options – including the superb Sea and Land Taste (S.A.L.T.) programme – yet small enough for the famed Silversea onboard ambience, Silver Dawn inherits the best features of her sister ships Silver Muse and Silver Moon, but is in a class all of her own. With sumptuous suites, outstanding itineraries, plus cutting-edge design and technology and the outstanding OTIVM wellness concept, Silver Dawn sets new standards of luxury. Wake up to a new dawn with Silversea.

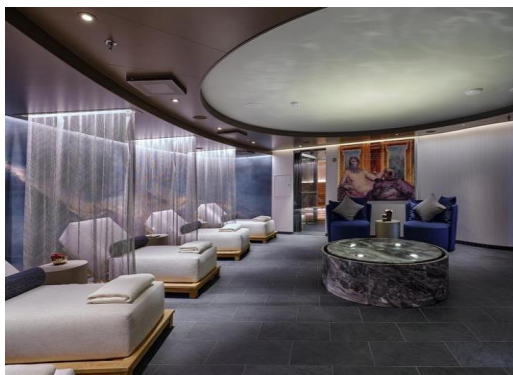

SUITES



VISTA SUITE

CATEGORY HIGHLIGHTS

- Deck 4 of 11
- Suite size 32 sq.m.

CATEGORY DETAILS

PRICES PER GUEST START FROM

PORT-TO-PORT

~~\$6,200~~

\$4,700



PANORAMA SUITE

CATEGORY HIGHLIGHTS

- Deck 9 of 11
- Suite size 31 sq.m.

CATEGORY DETAILS

PRICES PER GUEST START FROM

PORT-TO-PORT

~~\$6,500~~

\$5,000



CLASSIC VERANDA SUITE

CATEGORY HIGHLIGHTS

- Deck 5, 6 of 11
- Suite size 36 sq.m. including veranda
- Veranda size 6 sq.m.

CATEGORY DETAILS

PRICES PER GUEST START FROM

PORT-TO-PORT

~~\$7,000~~

\$5,500



DELUXE VERANDA SUITE

CATEGORY HIGHLIGHTS

- Deck 6, 7, 8 of 11
- Suite size 36 sq.m. including veranda
- Veranda size 6 sq.m.

CATEGORY DETAILS

PRICES PER GUEST START FROM

PORT-TO-PORT

~~\$7,800~~

\$6,300



086-5487333 / 084-0881847



@chicjourney



chic-2020.com



chicjourney2020

From Bergen To Copenhagen on 05 – 12 July, 2025

Category	Cruise Fare USD (Price Per Person)	Promotion Saving \$3,000 Per Suite* (Per Person)
Vista Suite	\$6,200	\$4,700
Panorama Suite	\$6,500	\$5,000
Classic Veranda Suite	\$7,000	\$5,500
Deluxe Veranda Suite	\$7,800	\$6,300

****Book by 31 October, 2024**

ALL INCLUSIVE ONBOARD BENEFITS

Enjoy the 24-hour gourmet dining, butler service, superb entertainment and premium beverages that Silversea is known for.



STAFF & SERVICES

- Butler services in every suite
- Nearly one crew member for every guest
- 24-hour dining service
- Complimentary transportation into town in most ports



LEISURE ONBOARD

- Multiple restaurants, diverse cuisine, open-seating dining
- Beverages in-suite and throughout the ship, including champagne, select wines and spirits
- Onboard entertainment
- Spa and Fitness Center



UTILITIES & AMENITIES

- Unlimited free WiFi
- Onboard gratuities



SHORE EXCURSIONS

On all classic cruises (on *Silver Muse*, *Silver Moon*, *Silver Dawn*, *Silver Spirit*, *Silver Whisper*, *Silver Shadow*, *Silver Nova* and *Silver Ray*) included shore excursions (one per guest/day, excluding "days-at-sea"), if available, will be offered on a complimentary basis.

Shore excursions will be bookable on "first-come-first-served" basis. Shore Excursions may require minimum participation levels to operate so it is recommended to sign up as early as possible. The deadline for booking Shore Excursions on MySilversea is 2 days prior departure date.

The "Shore Excursions Programme" is subject to shore excursion availability in each port and guests' first choice may not be available. The first shore excursion booked in a single day / port, among the shore excursions bookable and available within the Programme, will be considered included, while additional excursions will be charged at full fare. The Shore Excursion Programme does not apply in the embarking and disembarking port.



086-5487333 / 084-0881847

LINE

@chicjourney



chic-2020.com



chicjourney2020

CANCELLATION BY THE GUEST

The refundable percentage of cruise price in relation to the date of cancellation is shown below:

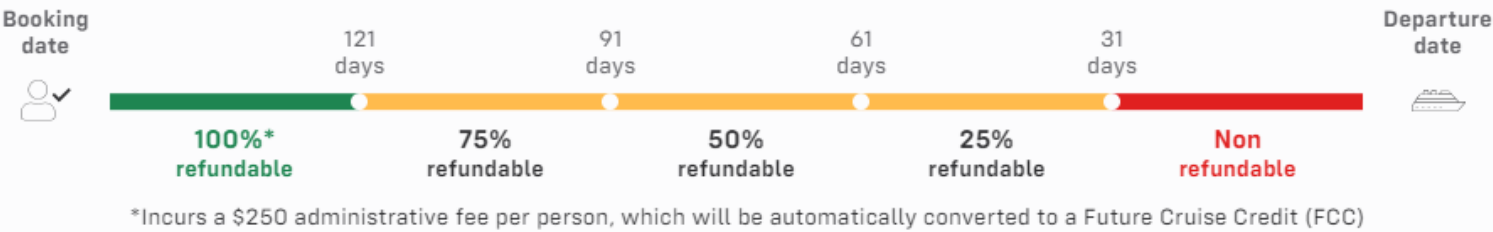

CANCELLATION BY SILVERSEA

If Silversea cancels a voyage, or delay embarkation by three (3) days or more and you elect not to sail on the delayed voyage or a substitute voyage we offer, you can obtain a refund or a Future Cruise Credit (FCC) for the amount paid.

